

REV.	DESCRIPTION	DATE	APPROVED
A		12/13/2012	

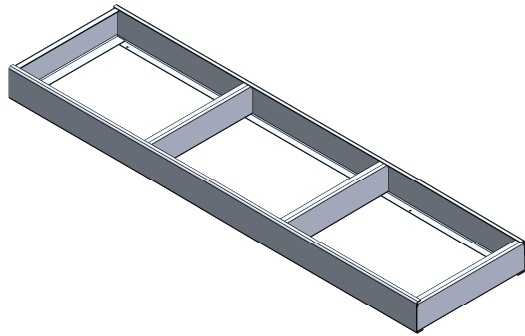

**ITD1098 No Divider**

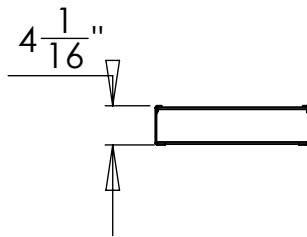
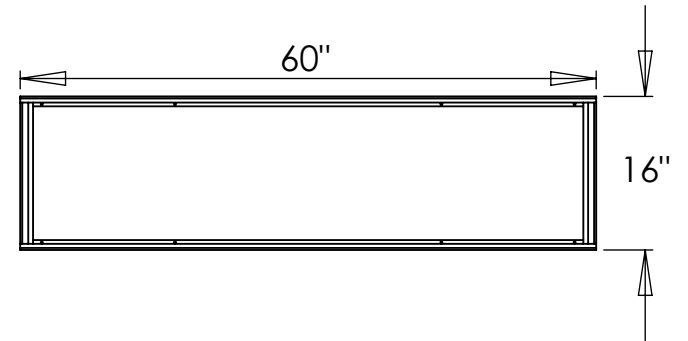

**ITD1098D With Divider**

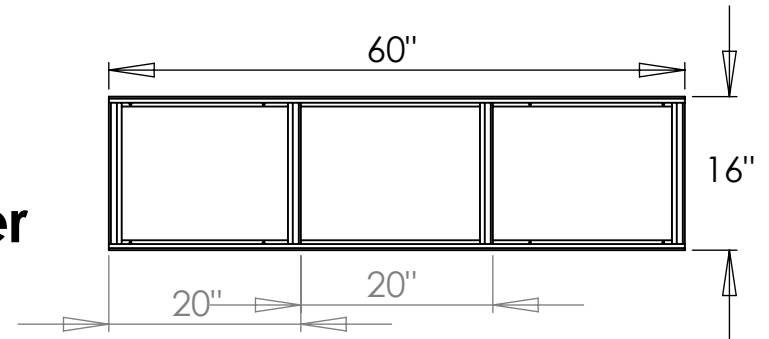

DRAWN BY: KBH	DRAWN DATE: 12/13/2012	Inventive LLC In The Ditch Towing Products	
UNLESS OTHERWISE SPECIFIED:		PART NAME 60" Alum Box Top	
DIMENSIONS ARE IN INCHES TOLERANCES: FRACTIONAL $\pm 1/16"$ ANGULAR: MACH $\pm 0.25^\circ$ BEND $\pm 1.5^\circ$ TWO PLACE DECIMAL $\pm 0.020"$ THREE PLACE DECIMAL $\pm 0.005"$		SIZE PART NO. <b>A</b> ITD1098-01	
MATERIAL: See BOM		SHEET SCALE 1:20	
DO NOT SCALE DRAWING		SHEET 1 of 1	