

Vehicle Positioning Dolly Rack

Models: GVPDR



INTENDED USE:

GUNI Vehicle Positioning Dolly Rack is designed to conveniently store 4 Vehicle Position Dollies so they are safely stored and easily accessible. Keeping the Dollies on this Rack when not in use makes for a clean, professional look and protects the Dollies by keeping them dry and out of the way of accidental damage.

SPECIFICATIONS:

Capacity (lb.):	300
Caster Size (in.):	5
Dimension (in.):	31 7/8 x 24 13/16 x 9 11/16
Weight (lb.):	22.7



WARNING

- Study, understand, and follow all instructions before using these stands.
- Do not exceed rated capacity.
- For use only on hard, level and smooth surfaces.
- DO NOT place the Vehicle Position Dolly Rack on an incline or uneven surface. The loaded weight is over 300 pounds, and it could roll away unexpectedly and damage property or cause injury.
- No alterations or modifications shall be made to the rack.
- Only attachments and/or adapters supplied by the manufacturer shall be used.
- Failure to heed these warnings may result in personal injury and/or property damage.
- Cancer and Reproductive Harm www.P65Warnings.ca.gov

ADDITIONAL SAFETY PRECAUTIONS

- Instructions, warnings, and safety information should be presented in the operator's native language before using these stands.
- Maintain a safe working environment. Keep work area clean and well lit.
- Do not use these racks if under the influence of alcohol, drugs, or medical prescriptions that will impair judgment or reflexes.
- The use of dolly racks is subject to certain hazards that cannot be precluded by mechanical means, but only by the exercise of intelligence, care, and common sense. Therefore, users must be careful, competent, trained and qualified in the safe operation of stands when servicing motor vehicles and their components.

ASSEMBLY INSTRUCTIONS

Following the diagram (page 2), attach the frames using the bolts (4) and nuts (1) provided and the 4 Casters (3) using the lock nuts (1) provided.

OPERATING INSTRUCTIONS

DO NOT place the Vehicle Position Dolly Rack on an incline or uneven surface. The loaded weight is over 300 pounds, and it could roll away unexpectedly and damage property or cause injury.

Place one Vehicle Positioning Dolly on each of the 4 holders.

MAINTENANCE

1. Clean any oil, grease or dirt from the Dolly Rack.
2. Always store the Jack Cradle in a well-protected area where it will not be exposed to inclement weather, corrosive vapors, abrasive dust or any other harmful elements.
3. Store out of the way so it does not create a trip hazard.
4. When maintaining, use only identical replacement parts.

Vehicle Positioning Dolly Rack



Models: GVPDR

PARTS LIST AND DIAGRAM

Index #	Description	Qty.
1	Nut	8
2	Right Frame	1
3	Casters	4
4	Bolt	4
5	Center Frame	1
6	Left Frame	1
7	Wrench	1

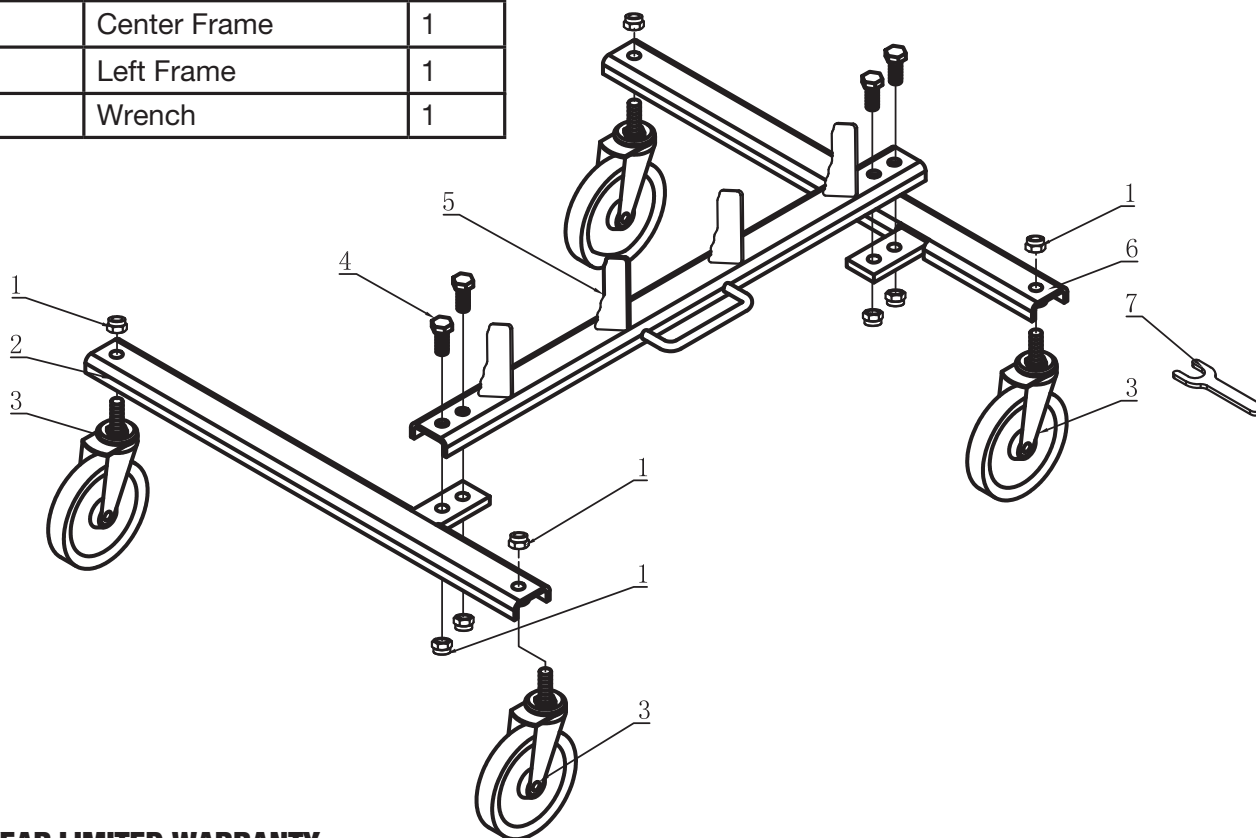

1-YEAR LIMITED WARRANTY

GUNI warrants that GUNI branded products are free from defects in workmanship and materials. We will repair or replace products that fail to give satisfactory service due to workmanship or materials.

The warranty for GUNI branded products is ONE YEAR from the date of the original purchase. The proof of purchase must be available for any warranty consideration. Repair or replacement shall be at the sole direction of GUNI.

GUNI warranty is administered where the original purchase was made. GUNI will not provide any warranty for any product subjected to misuse, modification, unreasonable use, neglect, lack of maintenance or use after the unit is significantly worn.

CONTACT US

Phone: 800-381-1029
guniproducs.com/warranty