

**THE WORLD LEADER IN HEAVY DUTY
DETACHABLE TOWING EQUIPMENT**



ZACKLIFT.COM

Defining the heavy-duty detachable industry since 1981, Zacklift International has been at the forefront of envisioning and manufacturing heavy-duty underlifts that have paved the way and helped define today's Heavy HDU industry. As the world leader in heavy-duty detachable towing, Zacklift International and its American-made, patented products are used by customers, state and local governments, as well as military divisions around the world.

In 1979, Ed Zackovich, Zacklift founder, began developing the original underfit. Back then, the traditional way to tow cars was to use a rubber sling and a chain. This became a problem when car manufacturers began focusing on reducing cost and weight to improve fuel economy and overall safety. The aerodynamic features, plastic bumpers, and Front Wheel Drive quickly made the traditional sling a destructive and challenging method of towing. Mr Zackovich, who was working in the tow industry, saw this problem and began brainstorming to fix it. While still running his International Harvester dealership and tow business, Mr. Zackovich hired three men to take his idea to the next level. The small team prototyped and tested multiple concepts over two years and eventually developed the very first Zacklift under lift. In 1982, the first Z5000 under-lift was produced and sold, establishing Zacklift as the first U.S. retrofit wheel/frame lift. Zacklift continued its development and sales of the heavy-duty detachable under lifts while continuing to improve unit designs, increasing lift and reach capacities, and patenting its unique products along the way.

In 2018, the founding family wanted to retire, and the Freeborn family acquired Zacklift International. Matthew Freeborn has over 35 years of manufacturing experience and considers himself a welder by trade and an engineer by education. The Freeborn family has been successfully involved with ownership of a manufacturing business since 1996. Mr. Freeborn and the Zacklift team are excited to preserve the Zacklift legacy by continuing to design and develop high-quality and durable heavy-duty towing equipment.



ATLAS / 35T

DETACHABLE OR PERMANENT

The ATLAS 35T is thoughtfully designed to be compact and balanced, making it a superior choice for towing and recovery work in tight areas and where recovery space is limited. Zacklift's innovative reinforced secondary boom gives the Atlas 35T one of the highest extended ratings on the market coming in at 22,000 lbs. The unit's under lift is rated at a very capable 35,000 lbs of lift and 80,000 lbs towing capacity.

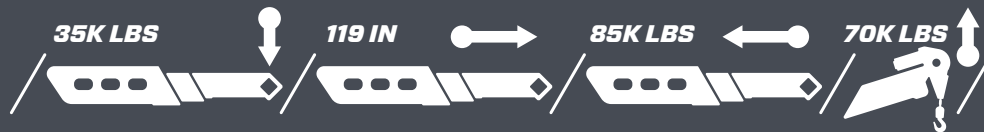

ATLAS

DETACHABLE OR PERMANENT

35T

THE WORLD LEADER IN HEAVY DUTY
DETACHABLE TOWING EQUIPMENT



The Zacklift ATLAS 35T represents the next evolution in detachable towing technology – a purpose-built, **independent 35-ton boom system** featuring our **patent-pending EVO 35K underlift**.

Engineered for maximum **level height, weight distribution, and efficiency**, the **ATLAS 35T** redefines what's possible in a detachable towing and recovery system. Designed for today's professional hybrid operators, the **ATLAS 35T** delivers true independence between boom and underlift, giving unmatched flexibility for complex recoveries and heavy-duty towing.

The new **EVO 35K underlift** features advanced geometry that moves the load forward while lifting, reducing the need for long wheelbases and improving balance. With an impressive **48 inches of level lift height**, the EVO 35K underlift provides one of the highest level-lift capabilities on the market – allowing operators to perform precision recoveries with smoother, faster setup and superior load control.

All of this comes in the compact, durable design Zacklift is known for. The **independent 35-ton boom** gives operators the reach and power needed for large-scale recovery and lifting operations. Zacklift's exclusive **boom stinger design** delivers more lifting strength at longer extensions than most wrecker booms on the market – offering exceptional capability with minimal added bulk or weight.

Like all Zacklift detachable systems, the **ATLAS 35T** offers **easy installation and quick changeover**. It's a modular, customizable system that can be permanently mounted or used as a detachable unit for maximum flexibility. Every ATLAS 35T ships complete with **five sets of forks and fork holders, safety chains, and a wireless remote**. Optional accessories include modular toolboxes, winch upgrades, wheel lift, fifth-wheel ball/pintle hitch combo, and the new **35XR extended-range underlift**.

The **Zacklift ATLAS 35T with EVO 35K underlift** isn't just stronger – it's smarter. It's the next generation of heavy-duty detachable towing technology, engineered to give operators **maximum capability, flexibility, and return on investment**.



PART # / AT-35T-WP / AT-35T-VIPP

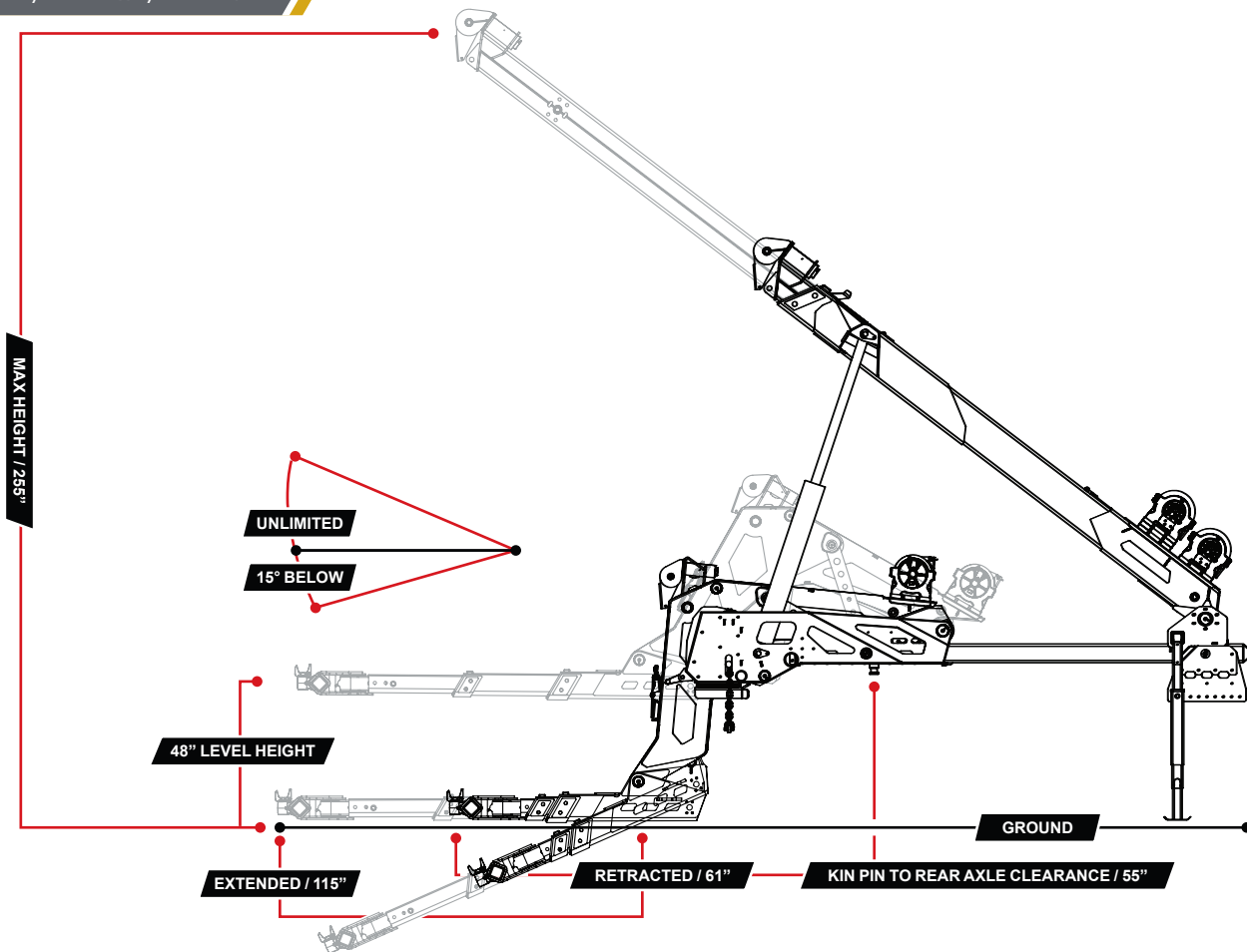

EVO 35K UNDERLIFT CAPACITY SPECIFICATIONS

UNDERLIFT CAPACITY - RETRACTED / 35,000 LBS / 15,876 KG

UNDERLIFT CAPACITY - EXTENDED / 16,000 LBS / 7,257 KG

UNDERLIFT MAX TOW CAPACITY / 85,000 LBS / 38,555 KG

UNDERLIFT TILT BELOW GROUND / 20 DEG

ATLAS 35T BOOM CAPACITY SPECIFICATIONS

BOOM (RETRACTED @ 30 DEG) / 70,000 LBS / 31,751 KG

BOOM MAX HOOK HEIGHT / 237 IN / 6,202 MM

UNDERLIFT REACH RETRACTED / 61 IN / 1,549 MM / XR - 71 IN / 1,803 MM

UNDERLIFT REACH EXTENDED / 115 IN / 2,921 MM / XR - 137 IN / 3,480 MM

UNDERLIFT MAX REACH W/ 12" EXTENSION / 131 IN / 3,327 MM / XR - 153 IN / 3,886 MM

BASE UNIT WEIGHT / 15,000 LBS / 6,803 KG

BOOM (EXTENDED @ 30 DEG) / 22,000 LBS / 9,979 KG

BOOM HYDRAULIC EXTENSION / 120 IN / 3048 MM

STANDARD / OPTIONAL

ATLAS 35T STANDARD EQUIPMENT

Wrecker & VIP Packages:

- Aerodyne or Flip-Door Toolboxes
- 38k Stifflegs w/ 18" Flip Feet (Bolt On)
- 2 EA 30k Hydraulic 2SPD Winch w/ 200' 5/8" Wire Rope
- 12 Button Wireless Remote
- Fork Rack
- 1" x 2.5" Fork (Pair)
- Torsion Bar Fork (Pair)
- 6" x 6.5" Fork (Pair)
- 9" x 4" Fork (Pair)
- Chain Fork slotted for 1/2" to 5/8" Chain (Pair)
- Chain Blocks (Pair)
- Universal Fork Receiver (Pair)
- 12" Reach Extender (Pair)
- 2 EA Safety Chains & Storage
- Breakaway Cable Tie-Back (Patent Pending)
- 36" LED wireless light bar
- EZ Hook Up (QD for Hydraulic Power & Glad Hands for Air)
- Quick Disconnect for Air Brakes & Air Tools
- Stop, Turn and Tail Lights

ATLAS 35T OPTIONS

- XR Underlift
- Saddle Bag Toolbox w/ Roll Up Door & Adjustable Shelves
- Zacklift Flip Up Door Toolboxes
- Warn 20k or 30k Hydraulic Winch w/ 200' 1/2" Wire Rope
- Custom Aluminum Round or Straight Style Fenders
- Fifthwheel Hitch with 20k Pintel & 2-5/16" Ball Combination
- Zacklift Aluminum Light Pylon
- LED Work Lights
- Heavy Duty Wheel Lift
- Specialty Forks
- Custom Graphic Toolbox Wrap
- Custom Paint

* Minor Assembly Required



WRECKER PACKAGE:

AT-35T-WP

Features: detachable 30 ton integrated boom with 8' hydraulic extension and a 35,000 lb underlift with 85,000 towing capacity

PACKAGE INCLUDES:

- 1 EA Base unit Atlas 35T boom, stifflegs, and underlift (P/N ZA000045-A)
- 2 EA Aerodyne toolbox 72" x 24" x 28.5" Deep (P/N TB-72X24)
- 2 EA 30k warn winch: includes 5/8" x 200' wire rope and 7 ton hook (P/N WRN-3000)
- 1 EA 36" wireless safety light bar
- 2 EA 8-button wireless remotes
- 5 EA Standard frame fork sets with fork rack
- 1 EA Cable tie-back system (patent pending)
- 1 EA Ezload stand
- 2 EA Safety chain (1/2" GR70 CHAIN 12' LONG)
- Painted Zacklift red or black unless otherwise quoted

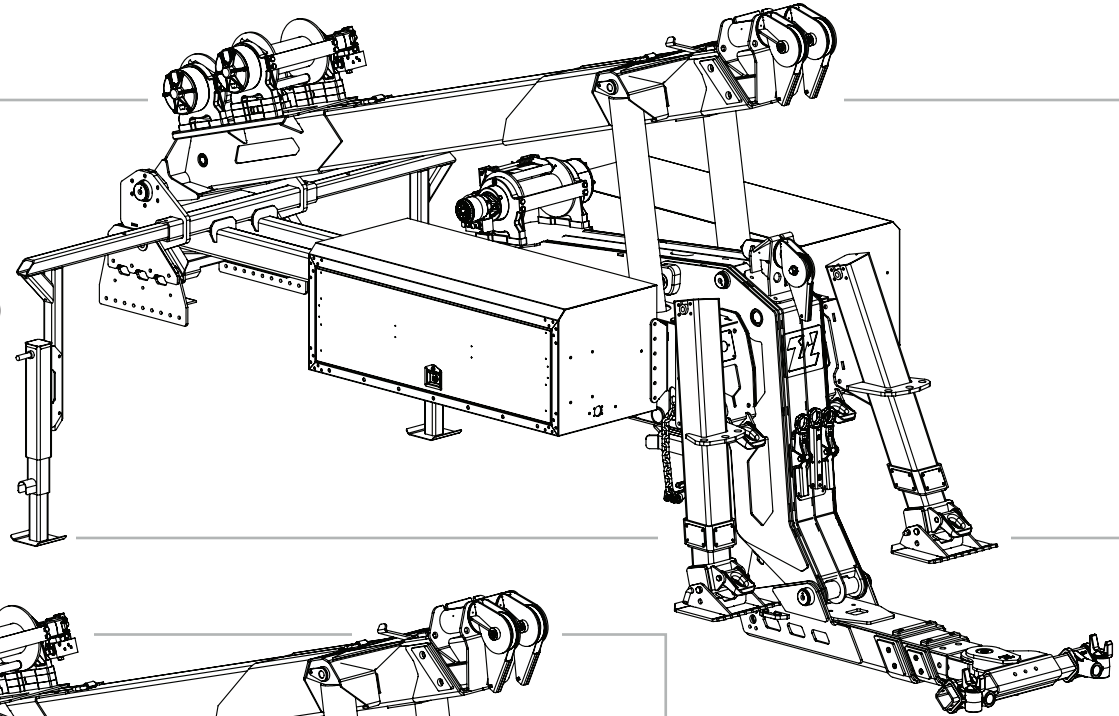

VIP PACKAGE:

AT-35T-VIPP

Features: detachable 30 ton integrated boom with 8' hydraulic extension and 35,000 lb underlift with 85,000 towing capacity

PACKAGE INCLUDES:

- 1 EA Base unit Atlas 35T boom, stifflegs, and underlift (P/N ZA000045-A)
- 2 EA Aerodyne toolbox 72" x 24" x 28.5" Deep (P/N TB-72X24-AERO)
- 2 EA Aerodyne toolbox 60" x 24" x 28.5" Deep (P/N TB-60X24-AERO)
- 2 EA Military style fender with mud flap (P/N FB-1000-M-EXT)
- 2 EA 30k warn winch: includes 5/8" x 200' Wire rope and 7 ton hook (P/N WRN-3000)
- 1 EA 36" wireless safety light bar
- 2 EA 8-button wireless remotes
- 5 EA Standard frame fork sets with fork rack
- 1 EA Cable tie-back system (patent pending)
- 1 EA Ezload stand
- 2 EA Safety chain (1/2" GR70 CHAIN 12' LONG)
- Painted Zacklift red or black unless otherwise quoted

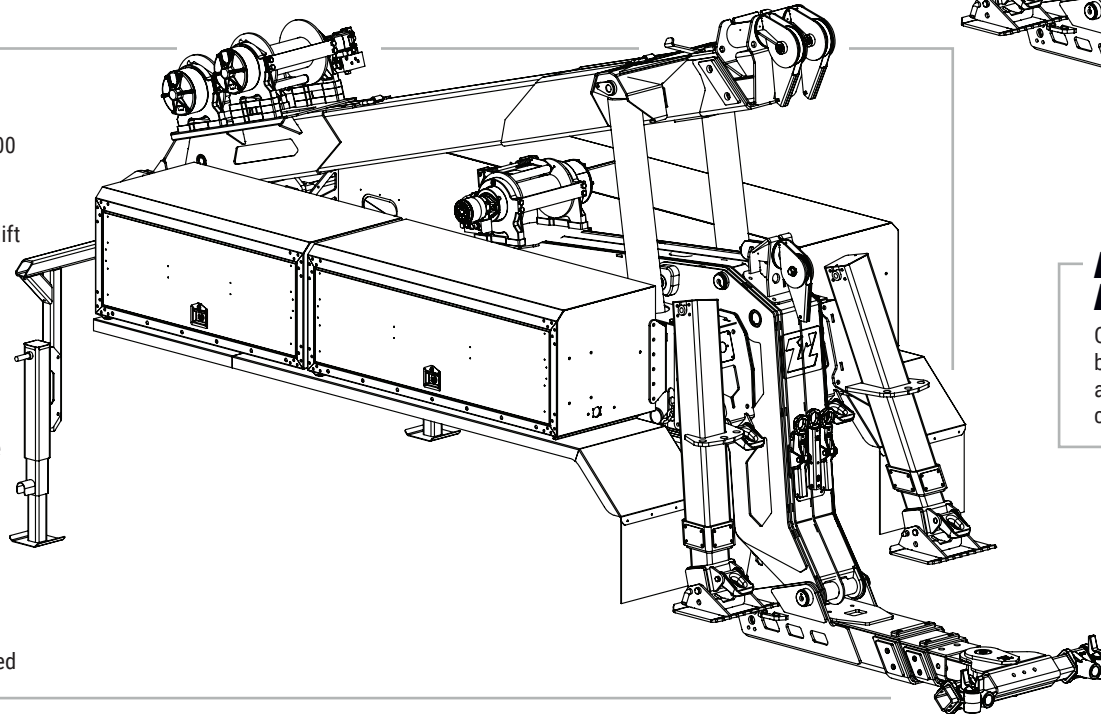

FULL CUSTOM PACKAGE:

Custom paint colors, custom tool box configurations, graphic wraps, and more. Contact sales today for a custom build sheet and more info.



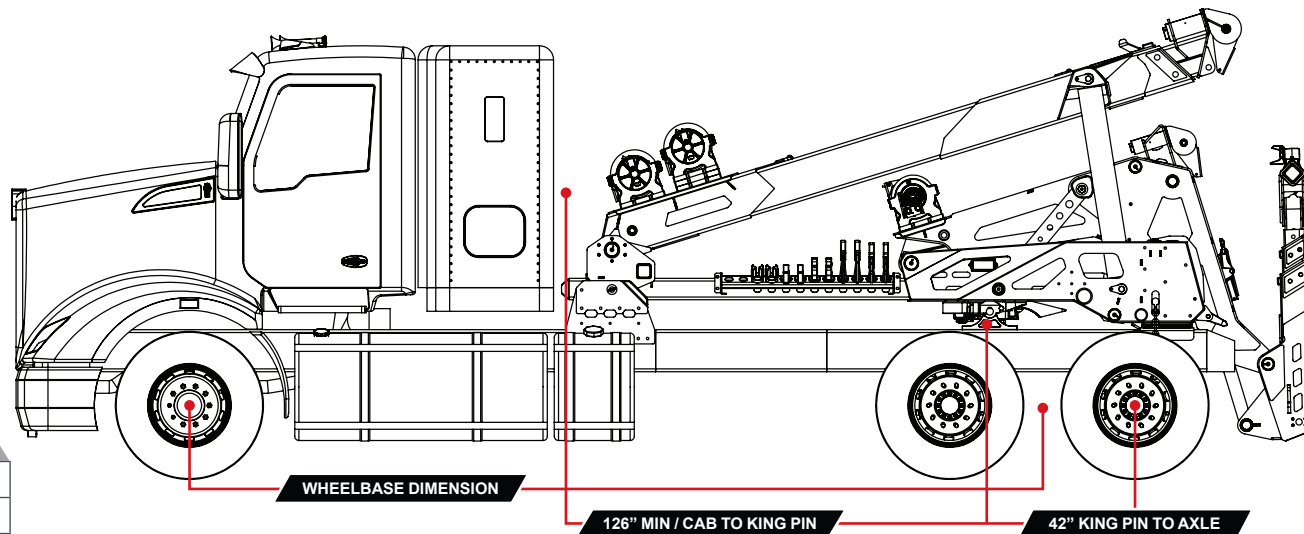

MINIMUM WHEELBASE RECOMMENDATIONS

NOTE: COUNTER WEIGHT MAYBE REQUIRED FOR SHORTER WHEELBASES

MODEL	IMPERIAL	METRIC
ATLAS 35T	280" +	7112 MM +

MINIMUM WHEELBASE RECOMMENDATIONS

MODEL	IMPERIAL	METRIC
ATLAS 35T	280" +	7112 MM +

HYDRAULIC REQUIREMENTS FOR PTO / PUMP (Z1304-52NC)

NOTE: 2 PUMPS ARE RECOMMENDED

CONFIGURATION	IMPERIAL FLOW RATE / PRESSURE		METRIC FLOW RATE / PRESSURE	
ATLAS 35T W/ STIFFLEGS & 2 WINCHES	10-12 GPM	2,500-3,000 PSI	38-45 LPM	172-207 BAR

ZACKLIFT CRATED SHIPPING WEIGHTS

MODEL	IMPERIAL	METRIC
ATLAS 35T	15,000 LBS	6,803 KG

GENERAL NOTES

- TRAILER GLAD HANDS FOR EMERGENCY AND SERVICE AIR
- TRAILER 7 WAY PLUG (TAIL LIGHTS AND 12V ACCESSORIES POWER)
- FIFTHWHEEL PLATE ON TRUCK MUST BE ADJUSTABLE
- TYPICAL CHASSIS FRAME WIDTH (OUTSIDE OF RAIL) IS 32" TO 35" OR (812 MM TO 889 MM)

ZACKLIFT INTERNATIONAL

PHONE / 844.ZACKLIFT / 509.674.4426

EMAIL / INFO@ZACKLIFT.COM

WEB / ZACKLIFT.COM

ADDRESS / 1102 E 1ST ST, CLE ELUM, WA 98922



FOLLOW US ON SOCIAL MEDIA

