

Yoke Puller

10803

**TIGER
TOOL**

Have What It Takes

Fits full and half round yokes on Spicer 1610,1710, 1760, 1810 series, Spicer SPL 140, 170, 250 series and Meritor (Rockwell) RPL 20 and 25 series.

Safety Warning

Read all instructions and safety warnings prior to operation. Failure to do so could result in equipment damage, personal injury or even death.

- **Stay Alert!** Watch what you are doing and use common sense when operating this tool.
- Inspect product for damage prior to using; do not use if product is in unsafe condition.
- Do not operate tool while under the influence of drugs, alcohol or medication.
- Always use safety equipment to prevent injuries. Approved face and eye protection must always be worn by the operator, as well as others in the work area.
- Do not overreach. Keep proper footing and balance at all times.
- Dress properly. Do not wear loose clothing or jewelry. Keep your hair, clothing and gloves away from moving parts.
- Keep your work area clean and well lit.

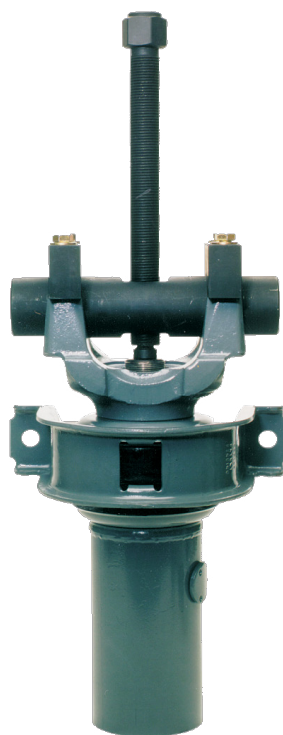

Tested and recommended by the Spicer Driveshaft Division of Dana Corporation.



View demonstration videos and a complete product list at tigertool.com

Technical Support
1.800.661.4661

Yoke Puller

10803

TIGER
TOOL

Have What It Takes

Fits full and half round yokes on Spicer 1610,1710, 1760, 1810 series, Spicer SPL 140, 170, 250 series and Meritor (Rockwell) RPL 20 and 25 series.

Operating Instructions

Use any quality oil on forcing screw.

Half Round Yoke

- 1 Remove the large nut and washer that retains yoke to shaft.
- 2 Apply penetrating lubricant to splines of the shaft, wing cap bolt holes, and forcing screw of tool.
- 3 Thread the forcing screw into the pull bar until threads begin to show through the other side.
- 4 Hold pull bar assembly by the forcing screw and position the tool onto the yoke. **Note:** pull bar end reliefs should face yoke.
- 5 Attach the adaptor cap by four bolts and then tighten down both caps.
- 6 Hand tighten the forcing screw until the center point aligns with the shaft center.
- 7 Using up to a 1" impact wrench, begin applying power to the forcing screw.
- 8 Continue turning the forcing screw until yoke is completely removed.

Full Round Yoke

- 1 Remove the large nut and washer retaining yoke to shaft.
- 2 Apply penetrating lubricant to splines of the shaft and forcing screw of the tool.
- 3 With the pull bar separated from the forcing screw, slide the bar through bearing cup bores until centered.
- 4 Thread the forcing screw into pull bar until it contacts the shaft.
- 5 Using up to a 1" impact wrench, begin applying power to the forcing screw.
- 6 Continue turning the forcing screw until the yoke is completely removed.

Here at Tiger Tool, your satisfaction is our number one priority. Should you have any questions about this or any of our products, please call us at 1.800.661.4661.



View demonstration videos and a complete product list at tigertool.com

Technical Support
1.800.661.4661

Yoke Puller

10803



Have What It Takes

Fits full and half round yokes on Spicer 1610,1710, 1760, 1810 series, Spicer SPL 140, 170, 250 series and Meritor (Rockwell) RPL 20 and 25 series.

Parts Breakdown

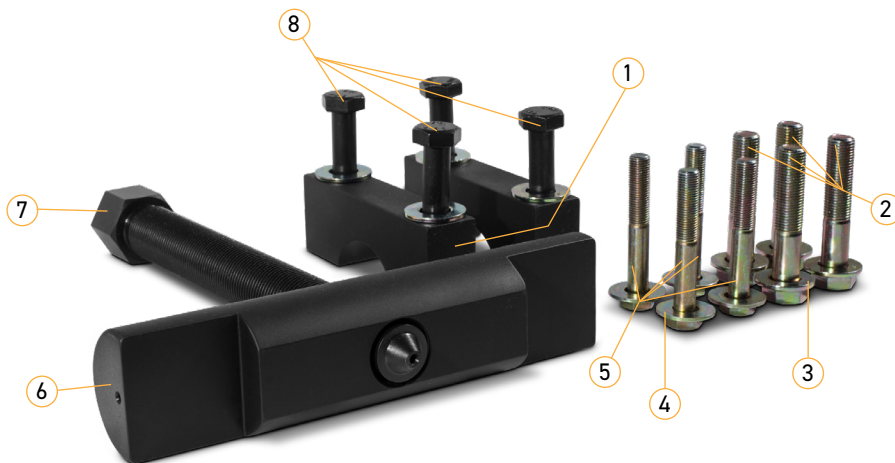

Item No.	Part Number	Description	Qty.
1	10803-12	Combined Cap	2
2	10803-4	1/2" - 20 x 2 1/2" Bolt	4
3	10407-4	1/2" Washer	8
4	10803-5	3/8" Washer	4
5	10201-2	3/8" - 24 x 2 1/2" Bolt	4
6	10803-1	Pull Bar	1
7	10803-11	Forcing Screw	1
8	10803-7	12mm x 1.25 x 70 Bolt	4



View demonstration videos and a complete product list at tigertool.com

Technical Support
1.800.661.4661