

REVISION HISTORY		
REV.	DESCRIPTION	DATE
A	INITIAL RELEASE PER CR# 1471	2005-03-25
B	CHANGED POWER CABLE PER P3# 08025	2008-10-02
C	REVISE PER LM14223	2015-03-06

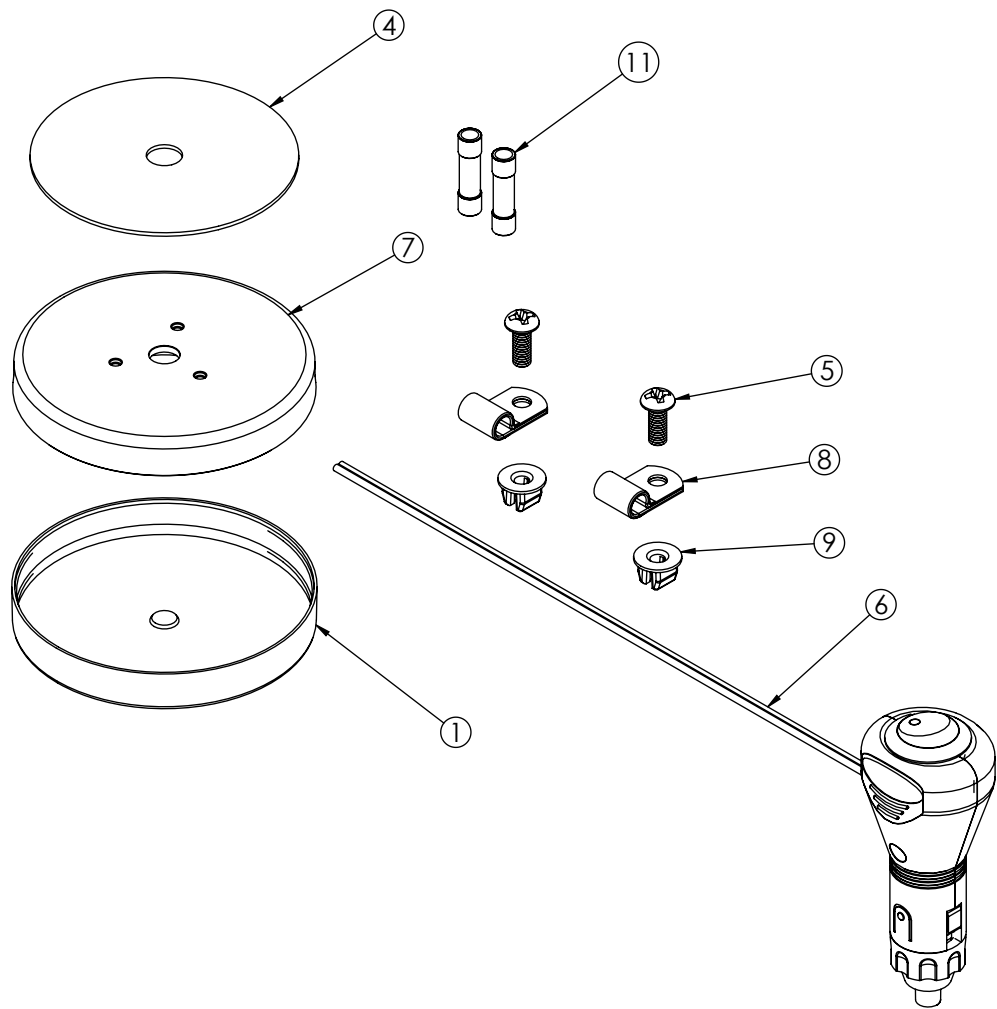

ITEM NO.	QTY.	DESCRIPTION	COMMENTS
1	1	COVER, MAGNET, 3.17"	
2	1	BOX, STROBE, 6400, 5 3/16 X 5 3/16 X 4 1/8	NOT SHOWN
3	1	BAG, POLY, 5" X 7"	NOT SHOWN
4	1	GASKET, ADHESIVE, FOR MAGNET	
5	2	SCREW, 10-32 X 1/2 PHIL PAN	
6	1	ASSY, CABLE, 2COND, 15', PLUG W/LED SWITCH	
7	1	MAGNET, 3" ROUND, W/COVER	
8	2	CLAMP, 3/16" STEEL W INSUL CABLE	
9	2	INSERT, BASE INT. MT 60SGN011400	
10	1	SHEET, INSTRUCTION, 6600 MAGNET M	NOT SHOWN
11	2	TERMINAL, 14-16 GA BUTT SPLICE	

SCALE 1:2		APPROVALS	DATE
CAD GENERATED DRAWING DO NOT MANUALLY UPDATE. MODEL REFERENCED: C		DRAWN BY ABB	2015-03-03
TOLERANCES ARE IN INCHES, AND MILLIMETERS TOLERANCES ARE:		CHECKED MDH	2015-03-04
MILLIMETERS DECIMALS XX. ± 1.0mm XX.X ± 0.5mm	INCHES DECIMALS X.X ± 0.1 X.XX ± 0.04 X.XXX ± 0.02	MECH. ENG.	
	ANGLES ± 0.5° FRACTIONS ± 1/64	ELEC. ENG.	
		TEST ENG.	
		SALES	
THIRD ANGLE PROJECTION		ELECTRONICALLY CONTROLLED USE LATEST COPY	

ECCO® Electronic Controls Co.
833 West Diamond Street, Boise, ID 83705
800-635-5900
www.eccolink.com

ACCESSORY MAGNET MOUNT KIT

CUSTOMER PART NO. A6600MK		PRODUCT SERIES: N/A	
SIZE: A	DWG. NO. A6600MK	REV. C	
SHEET 1 OF 1	Project: CR#1471	Date Created: 2005-03-18	

NON DISCLOSURE AGREEMENT
THIS DRAWING AND THE DESIGN IT DISCLOSES ARE THE PRIVATE PROPERTY OF ECCO AND IS ISSUED IN CONFIDENCE FOR ENGINEERING INFORMATION ONLY. THE DRAWING AND / OR DESIGN MAY NOT BE USED, COPIED, REPRODUCED, OR OTHERWISE DISCLOSED IN PART OR AS A WHOLE TO OUTSIDERS OR USED FOR ANY OTHER PURPOSE WITHOUT THE PRIOR WRITTEN CONSENT OF ECCO. THE DRAWING IS SUBJECT TO RECALL AT ANY TIME. YOUR POSSESSION OF THIS DOCUMENT CONSTITUTES ACCEPTANCE OF THESE TERMS. © 2005 ECCO