

INSTALLATION INSTRUCTIONS

- Remove existing bumpstop using 13 mm socket.
- Assemble Aeon rubber spring and bracket as shown in the adjacent diagram.
- Mount Timbren assembly using existing holes & Timbren supplied fasteners.

NOTES

Check that brake line or brake cable locations do not interfere with Aeon spring.

If OEM vehicle has a peg style casting as shown, Timbren Aeon® rubber spring is designed to contact peg. Do not remove OEM peg.

Do not exceed vehicle manufacturer's recommended axle weight rating. Check for AEON® interference with vehicle components - Under load AEON® will "expand" in diameter.

Ref. = Reference
Part = Part #.
Qty. = Quantity

| Ref | Part | Qty |
|-----|--------------|-------|
| 1 | K10546-003 | IL-IR |
| 2 | A00545-55Q30 | 2 |
| 3 | F11538-350 | 2 |
| 4 | F41308-050 | 2 |
| 5 | F11536-350 | 2 |

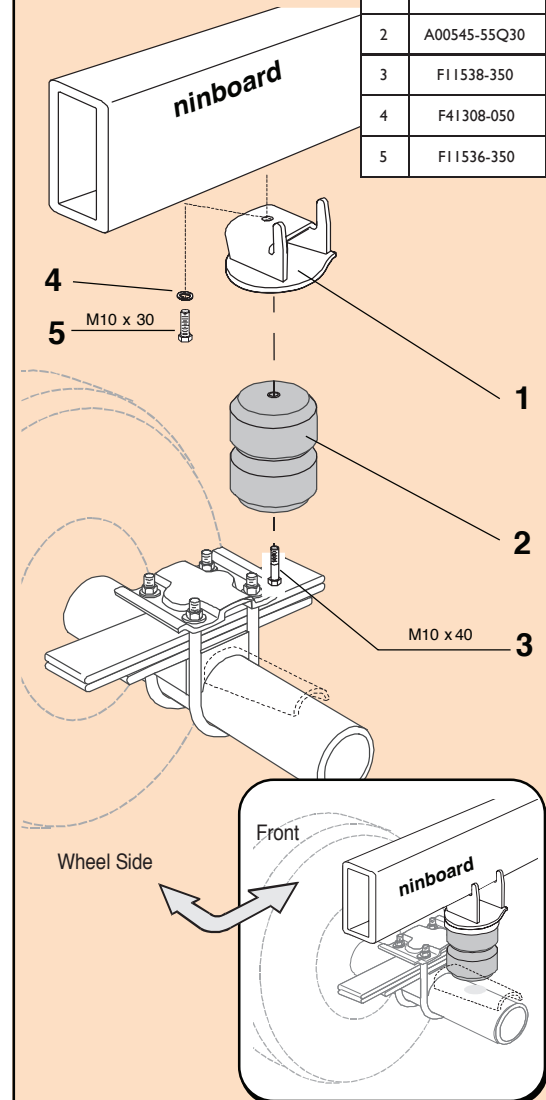

FR150RA

| PART NUMBER | DESCRIPTION | QTY | LOCATION |
|-------------------|--------------------------------|----------|------------|
| F41308-050 | WASHER SPLIT LOCK M10 Gr 8.8 Z | 2 | I1D |
| F11536-350 | HCS M10 x 30 x 1.5 Gr 8.8 Z | 2 | I1C |
| F11538-350 | HCS M10 x 40 x 1.5 Gr 8.8 Z | 2 | I1C |

| | | | |
|---------------------|----------------------|----------|------------|
| A00545-55Q30 | Hollow Rubber Spring | 2 | C9D |
|---------------------|----------------------|----------|------------|

| | | | |
|---------------------|-----------------------------|----------|-------------|
| K10546LH-003 | FR1504E WELDMENT LH PAINTED | 1 | D16F |
| K10546RH-003 | FR1504E WELDMENT RH PAINTED | 1 | D16E |

| | | | |
|-------------------|--------------------------------|----------|-------------|
| B90200-CR | SMALL REAR BOX - 9.5 x 7 x 5.5 | 1 | A--E |
| B10000 | 8" X 12" BUBBLE FOR KITS | 1 | |
| B00029-010 | BARCODE LABEL FOR KIT | 1 | |

Clearance Instructions:

Rear SES Kits for Pick-Ups and Vans should have a 1/2" to 1-1/2" gap between the rubber spring and contact point when empty.

A partial load, or vehicle accessories will reduce or eliminate the gap.

Front SES kits are usually in full contact.

Medium and Heavy-Duty Trucks, Trailers and Motorhomes will be in constant contact, and have no gap.