



CLEVIS SLIP HOOK GRADE 63/70

WORKING LOAD LIMIT: 2,750 TO 14,200 LBS.

BENEFITS & FEATURES

- Designed specifically for transport Grade 70 chain
- Design factor 4:1
- Hook embossed with trace code providing traceability throughout the manufacturing and testing process to heat of steel
- Durable orange powder coated finish

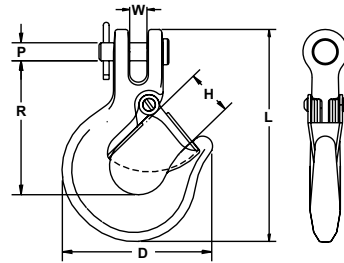

TRANSPORT CHAIN & ATTACHMENTS

Size (in.)	Working Load Limit (lbs.)		Finish	Standard Package	With Latch		Without Latch		Latch Kit	Dimensions (in.)					
	Grade 63	Grade 70			Product Code	Weight (lbs.)	Product Code	Weight (lbs.)		Product Code	W	D	H	L	R
1/4	2,750	–	Orange Paint	20	–	–	M904A	.50	–	0.32	2.63	0.94	3.67	2.31	0.33
5/16	3,600	4,700	Orange Paint	20	6905AWL	.96	M6905A	.91	4X1304	0.36	3.27	1.06	4.62	2.89	0.38
5/16	3,600	4,700	Yellow Chromate	20	6905AZL	.96	M6905AZ	.91	4X1304	0.36	3.27	1.06	4.62	2.89	0.38
3/8	5,500	6,600	Orange Paint	20	6906AWL	1.66	M6906A	1.61	4X1305	0.45	3.87	1.00	5.42	3.39	0.49
3/8	5,500	6,600	Yellow Chromate	20	6906AZL	1.66	M6906AZ	1.61	4X1305	0.45	3.87	1.00	5.42	3.39	0.49
5/16	3,600	–	Orange Paint	20	–	–	M905A	.75	–	0.38	3.18	1.06	4.27	2.54	0.38
3/8	5,500	–	Orange Paint	20	–	–	M906A	1.25	–	0.45	3.66	1.25	4.88	3.02	0.49
7/16	6,900	–	Orange Paint	10	–	–	M907A	2.00	–	0.50	4.31	1.56	5.69	3.48	0.50
1/2	9,400	–	Orange Paint	10	–	–	M908A	2.80	–	0.59	4.88	1.75	6.41	4.00	0.59
5/8	14,200	–	Orange Paint	5	–	–	M910A	5.00	–	0.81	5.69	2.00	7.56	4.75	0.75