

MOBILE CONTROL SYSTEMS, INC

1229 COMMONWEALTH AVENUE, MARIETTA, GEORGIA 30064 USA. PH: 678-581-9613, FAX: 770-421-9841

Web address: www.mobilecontrolsystems.com, e-mail: rbk@mobilecontrolsystems.com

Valve-Mate operator installation instructions for the Parker VDP-11/12 valve

Step 1. Unscrew and remove the original spring return cover, this cover will not be re-used.

Step 2. Remove ONLY the original retaining ring and spring cup. The original spring cup will not be re-used. (see the drawing on the reverse side.)

Step 3. Re-install the centering spring assembly using the threaded spring cup and flat washer using the snap ring and installation tool provided.

Step 4. Using the snap ring installation tool provided, place the snap ring on the spool end, using a light tap with a hammer, install the snap ring.

Step 5. Thread the round adapter into the valve body (this replaces the original spring cover removed in step 1). Thread the round adapter into the valve body until the valve lever centers up. You should be able to feel the position of the spring resting on the seat inside the round adapter. Move the lever up/down to make sure the spring is resting on the seat and has no free play between the spring and seat and that the valve spring centers properly. Note: Any free-play between the valve spring and the valve spring seat can allow unwanted spool movement and function operation.

Step 6. Insert a 1/8" allen or torx bit into the rear port of the Valve-Mate operator and thread the rod end into the threaded spring cup. Note: You will need to apply pressure to the spring by holding the lever to one side as you thread the rod end into the spring cup. Note: If you install the fitting in the side port and install the air line, WITH P.T.O.OFF) you can test the valve for full travel in one direction, once adjusted using the wrench in the rear port, you should have full valve travel in each direction.

Step 7. Tighten the two set screws on the Valve-Mate operator to the round adapter using a 1/8" allen wrench.

The hydraulic valve should be checked for free movement and centering, if any binding exists, check for the source of the problem before operating the system with the PTO engaged.

Adjustment: Lever up, insert your 1/8" allen or torx bit into the rear port and turn counterclockwise 1/8 of a turn. For lever down, turn 1/8 turn C.W. or until you have full lever travel in each using the remote. Install the fitting and test your system.

MOBILE CONTROL SYSTEMS, INC

Valve-Mate: Bolt on radio remote control systems for mobile hydraulic valves.

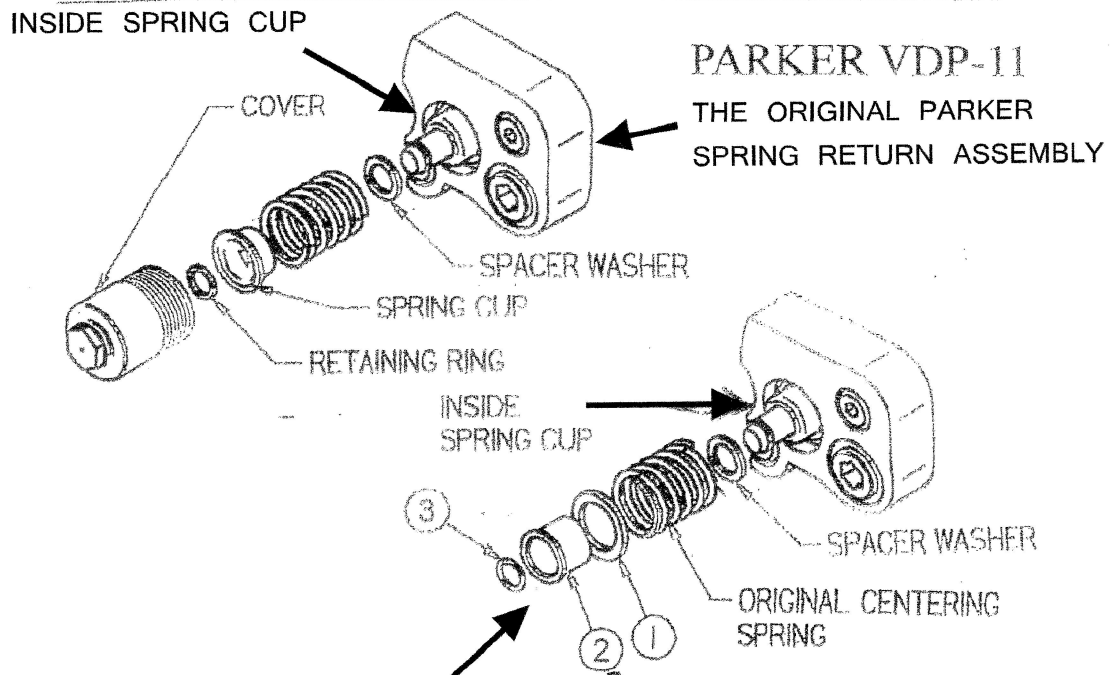

MCS VALVE-MATE
ASSEMBLY CHANGES
THE OUTER SPRING CUP
TO A TREADED SPRING CUP
TO MAKE THE *VALVE-MATE*
AIR CYLINDER ROD CONNECTION.