

HD/EX MOUNT KIT

16062400

GM 4500/5500 03+



SnowDogg™ Snowplow

TRUCK MOUNT INSTALLATION MANUAL

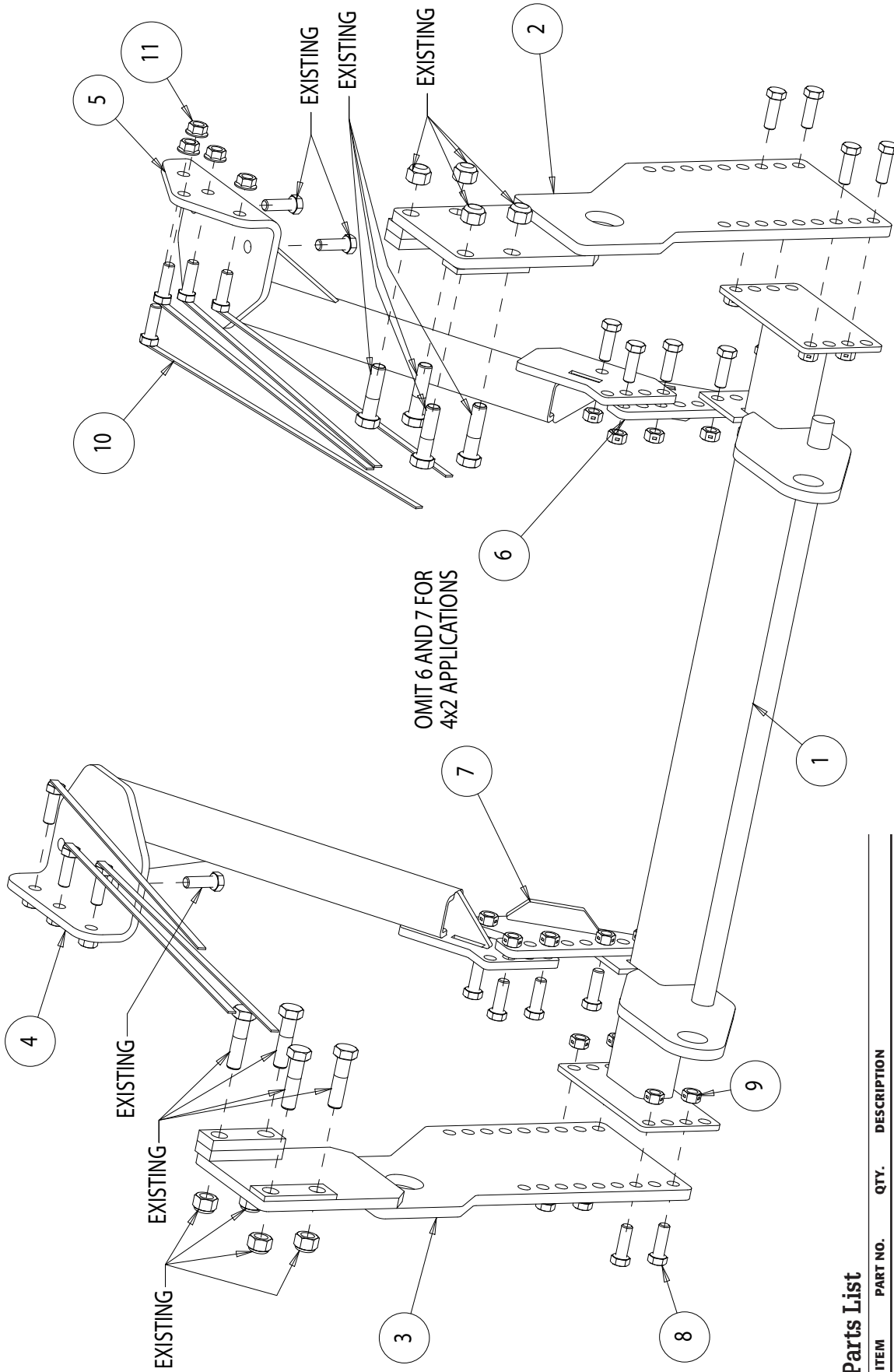



Parts List

ITEM	PART NO.	QTY.	DESCRIPTION
1	16062403	2	Pushbar, GM 4500/5500
2	16062406	1	Side Plate, GM 4500/5500, DS
3	16062404	1	Side Plate, GM 4500/5500, PS
4	16062408	1	Brace, Rear, PS, GM 4500/5500
5	16062410	1	Brace, Rear, DS, GM 4500/5500
6	16062412	1	Bracket, 4WD Conv, DS
7	16062414	1	Bracket, 4WD Conv, PS
8	3006202	18	Screw, Hex HD - 1/2-13 x 1-1/2 Gr. 8 ZN
9	3002397	18	Locknut, Hex 1/2-13, ZN Gr. 8
10	16801004	7	Screw, Hex HD, 1/2-13 x 1-1/2 Gr. 5 w/HDL
11	92401212	7	Nut, HX Flng - 1/2-13 ZN

INSTRUCTIONS

1. Remove the front bumper and bumper fasteners. Set aside for later reinstallation.
2. Remove the fasteners and nuts from the driver side frame connecting the leaf spring bracket and tow hooks to the frame. The tow hooks will not be reinstalled. The fasteners will be reused.
3. Using the removed fasteners from step 2, install the DS Side Plate (2) and leaf spring bracket as shown.
4. Repeat steps 2 and 3 for the PS Side Plate (3).
5. Mount the Pushbar (1) in place between the two side plates using eight ½-13x1-1/2 bolts and locknuts. The centerline of the pushbar crosspin should be approximately 10" from the ground. Improper mounting height will result in uneven cutting edge wear. It may be necessary to notch the bumper to achieve proper mount height.
For 2WD applications, it is recommended to shorten the side plates to ensure adequate ground clearance.
6. Remove the four bolts connecting the ABS module to the driver side frame rail. Remove and discard the existing bolt plate.
7. Remove the two fasteners in the bottom of the frame rail directly below the ABS module. These will be reused.
8. Install the DS Rear Brace (5) to the bottom of the frame using the fasteners from step 7.
9. Using four Hex Head Bolt's w/Handle (10) from the inside of the frame and four ½-13 Flanged Locknuts (11), secure the ABS Module and DS Rear Brace (5) to the side of the frame. It may be necessary to enlarge existing holes to Ø.531.
10. Remove the two fasteners in the bottom of the Passenger Side frame as shown. These fasteners will be reused.
11. Install the PS Rear Brace (4) to the bottom of the frame using the fasteners from step 10.
12. Using three Hex Head Bolt's w/Handle (10) from the inside of the frame and three ½-13 Flanged Locknuts (11), secure the PS Rear Brace (4) to the side of the frame. It may be necessary to enlarge existing holes to Ø.531.
13. In 2WD applications, the Rear Braces (4 and 5) should be secured to the Pushbar (1) with at least two ½-13x1-1/2 bolts (8) and locknuts (9) on each side.
14. In 4WD applications, it is necessary to use the 4WD Conversion Plates (6 and 7) between the Rear Braces and the Pushbar. These should be attached to the Rear Braces with three ½-13x1-1/2 bolts and locknuts, and secured to the pushbar with at least two ½-13x1-1/2 bolts and locknuts.
15. Torque all fasteners as shown in the chart. Check and re-torque all fasteners after 5 hours of usage to ensure safe plow operation.
16. It may be helpful to route the plow and light control harnesses at this point, prior to bumper reinstallation.
17. Reinstall the bumper assembly. The bumper may need to be altered or omitted for reinstallation.

Recommended Fastener Torque Chart (ft.-lb.)			
Size	 SAE Grade 2	 SAE Grade 5	 SAE Grade 8
1/4-20	6	9	13
5/16-18	11	18	28
3/8-16	19	31	46
3/8-24	24	46	68
7/16-14	30	50	75
1/2-13	45	75	115
9/16-12	66	110	165
5/8-11	93	150	225
3/4-10	150	250	370
7/8-9	150	378	591
1-8	220	583	893
Metric Grade 8.8 (ft.-lb.)			
Size	Torque	Size	Torque
M6	7	M12	60
M8	17	M14	95
M10	35	M16	155
These torque values apply to fasteners except those noted in the instruction.			

WARNING

- DO NOT under any circumstances disable, remove or relocate any sensors or components related to the operation of the air bags.
- Always follow the vehicle manufacturers' recommendations relating to snowplow installation.
- To comply with Federal Regulations and to assure a safe vehicle, the Front Gross Axle Weight Rating (FGAWR), Rear Gross Axle Weight Rating (RGAWR), and the Gross Vehicle Weight Rating (GAWR) must not be exceeded at any time.
- Due to the variety of equipment that can be installed on this vehicle, it is necessary to verify that the Front Gross Axle Weight Rating (FGAWR), Rear Gross Axle Weight Rating (RGAWR), and the Gross Vehicle Weight Rating (GAWR) are not exceeded at any time. This may require weighing the vehicle and adding ballast as necessary. It may also limit payload capacity of the vehicle. It is the operator's responsibility to verify that these ratings are not exceeded.

CAUTION

- Read all instructions prior to assembly
- It is critical that all fasteners be properly torqued for safe plow operation – see chart above.
- Fasteners should be retorqued after 5-8 hours of plow use

FULL ONE-YEAR WARRANTY

Manufacturer will repair, or at manufacturer's discretion will replace any part of this snowplow which proves to be defective in workmanship or material under normal use for a period of one year from the date of delivery to the original purchaser. Any cost incurred in returning the product to the supplier is the responsibility of the consumer.

EXCLUSIONS

Manufacturer shall not be liable for special, incidental, or consequential damages, or for damages resulting from lack of necessary maintenance, from misuse, abuse, acts of God, or alteration of the product. Some states do not allow the exclusion or limitation of incidental or consequential damages, so the above limitation or exclusion may not apply to you.